

# Kawasaki™

## 9" BAND SAW

### INSTRUCTION MANUAL

COMPONENT  
#691257

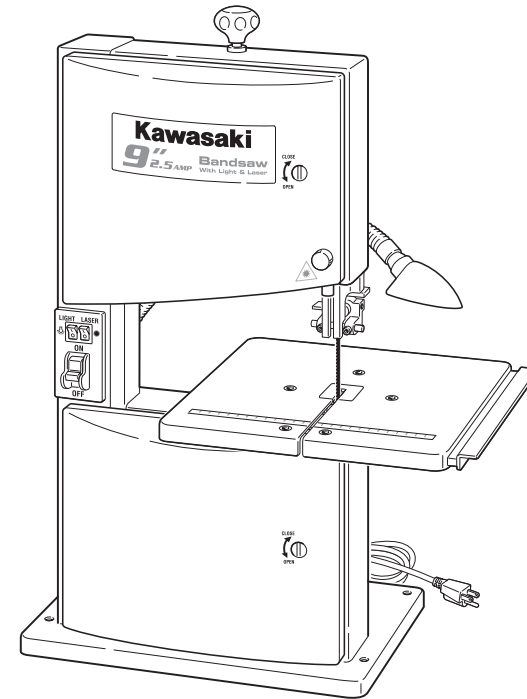

THIS MANUAL CONTAINS IMPORTANT INFORMATION REGARDING SAFETY, OPERATION, MAINTENANCE AND STORAGE OF THIS PRODUCT. BEFORE USE, READ CAREFULLY AND UNDERSTAND ALL CAUTIONS, WARNINGS, INSTRUCTIONS AND PRODUCT LABELS. FAILURE TO DO SO COULD RESULT IN SERIOUS PERSONAL INJURY AND/OR PROPERTY DAMAGE.

IF YOU SHOULD HAVE ANY QUESTIONS OR EXPERIENCE A PROBLEM WITH YOUR ALLTRADE PRODUCT, DO NOT RETURN THIS PRODUCT TO THE STORE. PLEASE CALL OUR CUSTOMER SERVICE DEPARTMENT AT **1-800-590-3723**. BEFORE YOU CALL, HAVE THE FOLLOWING INFORMATION AVAILABLE: MODEL No., DATE PURCHASED AND STORE LOCATION. AN ALLTRADE REPRESENTATIVE CAN RESOLVE YOUR PROBLEM OVER THE PHONE. IF YOU WOULD LIKE TO MAKE A SUGGESTION OR COMMENT, GIVE US A CALL OR EMAIL US AT: [INFO@ALLTRADETOOLS.COM](mailto:INFO@ALLTRADETOOLS.COM). YOUR FEEDBACK IS VITAL TO US.

## Kawasaki

Kawasaki Motors Corp., U.S.A.

OFFICIAL • LICENSED • PRODUCT

87-1904-60957

KAWASAKI™ IS A TRADEMARK LICENSED BY KAWASAKI™ MOTORS CORP., U.S.A., WHICH DOES NOT MANUFACTURE OR DISTRIBUTE THIS PRODUCT. CONSUMER INQUIRES SHOULD BE DIRECTED TO:

©COPYRIGHT 2006 ALLTRADE TOOLS, LLC.  
1431 VIA PLATA  
LONG BEACH, CA 90810-1462 USA

691257 - 9" Band Saw\_Rev. 8/18/06

**FOR CUSTOMER SERVICE**  
**POUR LE SERVICE APRÈS VENTE**  
**OU DU CONSOMMATEUR**  
**PARA EL SERVICIO**  
**PARA EL CONSUMIDOR**  
**1-800-590-3723**

Printed in China

**TABLE OF CONTENTS**

**CONGRATULATIONS!** ..... 2  
**INTENDED USE** ..... 2  
**SECTION ONE**  
 RECOGNIZE SAFETY SYMBOLS, WORDS AND LABELS ..... 2-3  
 IMPORTANT SAFEGUARDS ..... 3  
**SECTION TWO**  
 GENERAL SAFETY RULES – FOR ALL ELECTRIC POWER TOOLS .... 4-5  
 ELECTRICAL SAFETY ..... 5  
 ADDITIONAL SAFETY RULES FOR BAND SAWS ..... 5  
 GROUNDING INSTRUCTIONS ..... 5-6  
 EXTENSION CORD USAGE ..... 6  
 IMPORTANT SAFETY RULES FOR METAL CUTTING BAND SAWS .... 7-9  
 SYMBOLS ..... 10  
**SECTION THREE**  
 FUNCTIONAL DESCRIPTION ..... 11  
 ASSEMBLY ..... 12-22  
 ASSEMBLING THE TABLE ..... 12-13  
 INSTALLING THE WORKLIGHT ..... 13  
 OPERATING THE WORKLIGHT ..... 13  
 CONNECTING THE DUST COLLECTOR ..... 13  
 MOUNTING THE SAW TO A WORKBENCH ..... 14  
 OPENING THE HOUSING DOORS ..... 14-15  
 ADJUSTING THE UPPER BLADE ..... 15-16  
 ADJUSTING THE THRUST BEARING ..... 16  
 ADJUSTING THE UPPER GUIDE BEARING ..... 17  
 ADJUSTING THE LOWER BLADE GUIDE ..... 17-18  
 ADJUSTING THE RIP FENCE ..... 18  
 ADJUSTING THE MITER GAUGE ..... 18  
 ADJUSTING THE BEVEL ANGLE ..... 19  
 ADJUSTING SAW BLADE TENSION ..... 19-20  
 ADJUSTING BLADE TRACKING ..... 20  
 SETTING THE TABLE SQUARE WITH THE BLADE ..... 21  
 INSTALLING THE BAND SAW BLADE ..... 21-22  
 LASER GUIDE ..... 22-24  
 LASER SAFETY ..... 23  
 OPERATING THE LASER ..... 24

OPERATING THE BAND SAW ..... 24-25  
 FEEDING WORK INTO THE SAW ..... 25  
**SECTION FOUR**  
 MAINTENANCE AND CLEANING ..... 26  
 ACCESSORIES ..... 26  
 SPECIFICATIONS ..... 27  
 OTHER CONSUMER DO-IT-YOURSELF (DIY) TOOLS ..... 27  
**SECTION FIVE**  
 3 YEAR LIMITED WARRANTY ..... 27-30

**CONGRATULATIONS!**

Thanks for choosing this product. At Alltrade, our aim is to provide you with quality products at an affordable price, and we want you to be totally satisfied with your product and our Customer Service. If any help and advice is needed, please contact us at 1-800-590-3723. Properly cared for, this product will give you many years of satisfaction.

**INTENDED USE**

This product is intended for consumer use only. This tool is not designed for professional use. The power cord should only be used in approved electrical outlets as described in this manual. Failure to use the proper power cords and/or extension cords may result in fire or possible damage to the band saw.

**RECOGNIZE SAFETY SYMBOLS, WORDS AND LABELS**

**⚠ WARNING** **READ AND UNDERSTAND ALL INSTRUCTIONS.** Failure to follow all instructions in this manual may result severe personal injury or death. Keep this manual and refer to it for Safety Instructions, Operating Procedures and Warranty.

The safety instructions provided in this manual are not intended to cover all possible conditions and practices that may occur when operating, maintaining and cleaning power tools.

Always use common sense and pay particular attention to all the **DANGER, WARNING, CAUTION** and **NOTE** statements of this manual.



This is the safety alert symbol. It is used to alert you to potential personal injury hazards. Obey all safety messages that follow this symbol to avoid possible injury or death.

**⚠ DANGER**

**DANGER** indicates an imminently hazardous situation which, if not avoided, will result in death or serious injury.

**⚠ WARNING**

**WARNING** indicates a potentially hazardous situation which, if not avoided, could result in death or serious injury.

**⚠ CAUTION**

**CAUTION** indicates a potentially hazardous situation which, if not avoided, may result in minor or moderate injury.

**CAUTION**

**CAUTION** used without the safety alert symbol indicates a potentially hazardous situation which, if not avoided, may result in property damage.

**NOTE**

**NOTE** provides additional information that is useful for proper use and maintenance of this tool. If a NOTE is indicated make sure it is fully understood.

**IMPORTANT SAFEGUARDS**

**⚠ DANGER**

People with electronic devices, such as pacemakers, should consult their physician(s) before using this product. Operation of electrical equipment in close proximity to a heart pacemaker could cause interference or failure of the pacemaker.

**WARNING:** Some dust created by power sanding, sawing, grinding, drilling and other construction activities contains chemicals known to the State of California to cause cancer, birth defects or other reproductive harm.

Some examples of these chemicals are:

- Lead from lead-based paints.
- Crystalline silica from bricks and cement and other masonry products, and arsenic and chromium from chemically-treated lumber.

Your risk from these exposures varies, depending on how often you do this type of work. To reduce your exposure to these chemicals: work in a well ventilated area, and work with approved safety equipment, such as dust masks that are specially designed to filter out microscopic particles.

**WARNING:** Handling the power cord on corded products may expose you to lead, a chemical known to the State of California to cause cancer and birth defects or other reproductive harm. *Wash hands after handling.*

**GENERAL SAFETY RULES – FOR ALL ELECTRIC POWER TOOLS**

**⚠ WARNING**

**READ AND UNDERSTAND ALL INSTRUCTIONS.** Failure to follow all instructions listed below may result in electric shock, fire and/or serious personal injury.

**ALWAYS USE SAFETY GLASSES. ALSO USE FACE OR DUST MASK IF CUTTING OPERATING IS DUSTY.** Everyday eyeglasses only have impact resistant lenses: they are not safety glasses.

**KEEP ALL SAFETY GUARDS IN PLACE AND IN WORKING ORDER.**

**REMOVE ADJUSTING KEYS AND WRENCHES.** Always check that keys and adjusting wrenches are removed from the work area before operating the equipment.

**KEEP WORK AREA CLEAN. REMOVE CLUTTER.**

**DO NOT USE EQUIPMENT IN A WET OR IN DANGEROUS ENVIRONMENT.** Keep the work area well lit.

**KEEP ALL NON-WORKERS AT A SAFE DISTANCE FROM THE WORK AREA.**

**MAKE THE EQUIPMENT AND WORK AREA SECURE BY USING PADLOCKS, MASTER SWITCHES, OR BY REMOVING STARTER KEYS.**

**DON'T FORCE THE EQUIPMENT.** Use it for which it was designed.

**USE THE RIGHT TOOL OR ATTACHMENT.** Don't force a tool or attachment to do a job for which it was not designed.

**USE THE PROPER EXTENSION CORD. MAKE SURE YOUR EXTENSION CORD IS IN GOOD CONDITION.** When using an extension cord, be sure to use one heavy enough to carry the current your product will draw.

**WEAR PROPER CLOTHING.** Do not wear loose clothing, gloves, neckties, rings, bracelets, or other jewelry that can get caught in moving parts. Nonskid footwear is recommended, Wear protective hair covering to contain long hair.

**SECURE WORK PIECES.** Use clamps or a vise to hold objects in place.

**DON'T OVERREACH.** Keep proper footing and balance at all times.

**MAINTAIN TOOLS.** Keep them sharp and clean for best and safest performance.

**FOLLOW INSTRUCTIONS FOR LUBRICATING AND CHANGING ACCESSORIES.**

**REMOVE POWER TO THE BAND SAW BEFORE SERVICING, WHEN CHANGING BLADES AND MAKING ADJUSTMENTS.**

**⚠ WARNING**

**MAKE SURE THE POWER SWITCH IS IN "OFF" POSITION** before plugging in to prevent unintentional starting.

**USE ONLY RECOMMENDED ACCESSORIES.** See the table provided.

**NEVER LEAVE THE EQUIPMENT RUNNING UNATTENDED. TURN POWER OFF.** Don't leave the work area until it comes to a complete stop.

**ELECTRICAL SAFETY**

**⚠ WARNING**

**USE PROPER GROUNDING** techniques in accordance with **ALL** local codes and ordinances.

**DO NOT MODIFY** the plug provided. If it will not fit the outlet, have the proper outlet installed by a qualified electrician.

**REPAIR OR REPLACE** damaged or worn cords immediately.

**ADDITIONAL SAFETY RULES FOR BAND SAWS**

**⚠ WARNING**

**DO NOT STARE** into the laser beam.

**NEVER AIM** the laser beam at any person or an object other than the work piece.

**NEVER AIM** the laser beam at a work piece with a reflective surface.

**WEAR EAR PROTECTION.** Wear a breathing mask. Wear eye protection.

**DO NOT REMOVE** jammed cutoff pieces until the blade has stopped.

**MAINTAIN PROPER ADJUSTMENT** of blade tension, blade guides, and thrust bearings.

**PERIODICALLY CHECK** that all nuts, bolts and other fixings are properly tightened.

**DO NOT STORE** materials or equipment above a machine in such a way that they could fall into it. Ensure that your work is always on the table. Never make a cut with the work off the table.

**GROUNDING INSTRUCTIONS**

The electrical power source for this band saw **MUST** be grounded in order prevent possible electric shock or even death should the tool malfunction or breakdown. Grounding provides a path of least resistance for electric current thus reducing the risk of electrical shock. The power source must also use a minimum 20A service and not used if other power tools on the same circuit are in use.

This band saw is equipped with a grounded 3-wire power cord with a 3-prong plug.

If the power cord will not fit into the wall plug, an approved adapter can be used as long as it is connected to the center screw in the wall plate. **Never modify the electrical plug** by cutting off the grounding prong so it will fit into unapproved, ungrounded electrical receptacles.

If you have questions about hooking up the band saw, contact a certified electrical contractor to install the proper circuitry acceptable for this and other power tools you use. Repair or replace any damaged electrical wiring **IMMEDIATELY.**

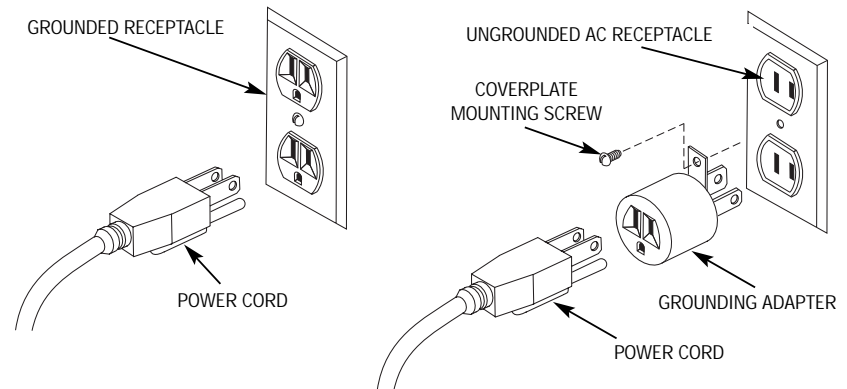

FIGURE 1. CONNECTING THE BAND SAW TO THE AC POWER RECEPTACLE

**EXTENSION CORD USAGE**

Extension cords, if used, must be properly grounded with a 3-prong plug on one and a 3-hole receptacle on the other. **DO NOT use grounding adapters with an extension cord.** Extension cords must be UL listed and use a minimum of 18 A.W.G. wiring. Extension cords should never exceed 25 feet in length. Extension cords, that are too long, cause a voltage drop over the extra distance causing the grinder motor to run slower with the possibility of causing damage to the motor. Using extension cords with smaller than the recommended wire gauge run the risk of getting too hot, melting, and/or causing fires. See table, "Extension Cord Specifications", on page 26.

**⚠ WARNING**

Use proper grounding techniques. Improper connection of the equipment grounding conductor can result in a risk of electric shock resulting in personal injury or death.

**⚠ WARNING**

If repair or replacement of the electric cord or plug is necessary: **DO NOT** connect the equipment grounding conductor to a live terminal. Failure to do so can result in personal injury or death.

**NOTE**

In the event of a malfunction or breakdown, grounding provides a path of least resistance for electrical current to reduce the risk of electric shock.

**IMPORTANT SAFETY RULES FOR BAND SAWS****⚠ WARNING**

**READ AND UNDERSTAND ALL INSTRUCTIONS.** If there are instructions in this manual that are not completely understood, seek the advice of a trained professional or contact Alltrade Customer Service at 1-800-590-3723 before attempting to perform the procedures. Failure to follow all instructions listed in this manual may result in property damage, damage to the tool, or serious personal injury or even death.

**UNPACK THE BAND SAW COMPLETELY FROM ITS CARTON.** Inspect the saw and accessories and ensure they are free from defects or breakage due to shipping.

**DO NOT OPERATE THIS BAND SAW** until it is completely assembled according to the instructions in this manual. Failure to adhere to these instructions could result in serious and/or permanent injury to the operator.

**MAKE SURE APPROVED EYE PROTECTION IS BEING WORN** and properly adjusted and secured at all times the band saw is in use. Everyday eyeglasses only have impact resistant lenses and ARE NOT safety glasses. Safety glasses must conform to ANSI Z87.1 requirements. Approved safety glasses and goggles will have Z87 printed or stamped on them.

**FOLLOW ALL WIRING CODES.** Use only properly grounded three-hole grounded receptacles. DO NOT cut the third prong off the power cord. When using an extension cord, use only UL Listed extension cords with minimum 16 AWG wiring and a maximum length of 25 feet. See ELECTRICAL SAFETY section in this manual.

**KEEP BYSTANDERS, CHILDREN, AND VISITORS** at a safe distance from the band saw while it is in operation. Distractions can cause inadvertent misuse resulting in possible injury to the bystanders or to the operator.

**WEAR PROPER APPAREL.** Do not wear loose clothing, gloves, neckties, rings, bracelets, or other apparel that could possibly become caught in the moving parts of the band saw. When working in a shop environment around power tools, wear nonslip footwear. Use protective hair covering to contain long hair.

**KEEP THE WORK AREA CLEAN AT ALL TIMES.** Cluttered areas around the band saw can cause unexpected accidents if the debris comes in contact with the moving parts of the band saw.

**⚠ WARNING**

**MAINTAIN A PROPER WORK ENVIRONMENT.** Do not operate the band saw in damp or wet locations or expose it to rain. Water can cause the electrical components to malfunction resulting in damage to the band saw and/or serious injury or death to the operator.

**ALWAYS USE APPROVED TABLE CLAMPS AND VICES** to clamp workpieces to the band saw table to prevent breakage, damage to the tool, the workpiece, and possible severe injury to the operator. Contact Alltrade Customer Service at 1-800-590-3723 (toll free) for authorized accessories.

**USE ONLY BAND SAW BLADES** that were designed for this tool. Unsuitable blades can break without warning throwing fragments outward at high speeds possibly causing severe injuries. Contact Alltrade Customer Service at 1-800-590-3723 (toll free) for authorized abrasive wheel specifications.

**DO NOT FORCE THE TOOL.** The band saw will do a better job and be safer if cutting operations are performed at the proper speeds as expressed in this manual.

**ALWAYS EASE THE BAND SAW BLADE AGAINST THE WORKPIECE** when starting a cutting operation. A sudden impact can cause the abrasive wheel to break sending fragments flying away from the band saw at high speeds resulting in possible severe injury to the operator.

**DO NOT USE THE BAND SAW IF THE BLADE VIBRATES.** Visually inspect the blade wheels to ensure the blade is properly positioned in the guides. If the vibration still exists, check the bearings and the motor shaft and repair or replace them as soon as possible. EXCESSIVE VIBRATION can cause severe damage to both the workpiece and the band saw. DISCONNECT AC POWER BEFORE ANY ADJUSTMENTS TO THE BLADE ARE MADE.

**ADJUST THE TOOL TABLE BEFORE EACH USE.** The tool table should be tightened and placed at the proper angle for the cutting job before the band saw is put into use. If not properly adjusted, the workpiece can unexpectedly move causing the abrasive wheel to seize resulting in damage to it or possible severe injury to the operator.

**PROPERLY SUPPORT EXTRA LONG OR EXTRA WIDE WORKPIECES.** Workpieces that are too long or too wide can tip and cause the band saw blade to seize resulting in a sudden kick back motion resulting in damage to the workpiece and band saw as well as possible severe injury to the operator.

**⚠ WARNING**

**NEVER START THE BAND SAW WITH THE WORKPIECE IN CONTACT WITH THE BAND SAW BLADE.** The sudden start-up of the band saw blade could cause it to break resulting in pieces flying away from the band saw resulting in damage to the workpiece, the band saw, and/or serious injury to the operator.

**DISCONNECT THE BAND SAW POWER CORD FROM THE AC OUTLET** before making adjustments to the worktable, clamps, vises, workpieces, changing abrasive wheels, or changing the speed of the drill motor preventing the tool from accidentally turning on. Failure to adhere to this step could result in damage to the workpiece and the band saw as well as possible severe injury to the operator.

**NEVER PERFORM CUTTING OPERATIONS NEAR FLAMMABLE GAS OR LIQUIDS.** The resulting fire and/or explosion could cause permanent serious injuries to the operator and damage to the band saw and surrounding work area.

**ALWAYS KEEP ARMS, HANDS, AND FINGERS** away from the workpiece while it is on the table and the band saw is turned on. Severe injury could result.

**EXTREME CARE SHOULD BE TAKEN WHEN THE BAND SAW IS IN THE VERTICAL POSITION.** It is important to keep hands away from the moving blade both above and below the work table. A sudden slip could bring hands in contact with the moving blade possibly resulting in severe injuries to the operator.

**ALWAYS CLAMP THE WORKPIECE FIRMLY AGAINST THE WORK TABLE.** Never attempt to hold the workpiece by hand. The band saw blade can seize in the workpiece resulting in loss of control of the workpiece possibly causing severe injuries to the operator and/or damage to the workpiece and band saw.

**KEEP THE BELT GUARD AND BLADE COVER IN PLACE.** It is very important that these covers be in place and in proper working condition when the band saw is being used.

**REDUCE THE RISK OF UNINTENTIONAL STARTING.** Ensure the "ON/OFF" switch is set to the "OFF" position before plugging the power cord into the AC outlet.

**TURN THE ON/OFF SWITCH ON THE BAND SAW TO THE "OFF" POSITION AND UNPLUG THE POWER CORD FROM THE ELECTRICAL RECEPTACLE** when the cutting operations are finished. Thoroughly clean the area surrounding the band saw making it ready for the next use.

**NEVER LEAVE THE BAND SAW RUNNING UNATTENDED. WHEN FINISHED WITH A CUTTING OPERATION, TURN "OFF" THE BAND SAW AND WAIT UNTIL IT COMES TO A COMPLETE STOP.**





**⚠ WARNING**

**SECURE THE ELECTRICAL POWER CORD WHEN THE BAND SAW IS NOT IN USE** to prevent unauthorized use of the tool and/or to prevent children from accidentally turning it on. Department of Labor OSHA 1910.213 Regulations.

**ADDITIONAL INFORMATION** about the proper use of band saws is available from the Power Tool Institute; 1300 Sumner Avenue, Cleveland, OH 44115-2851 or at the following website, [www.powertoolinstitute.com](http://www.powertoolinstitute.com). Information is also available from the National Safety Council; 1121 Spring Lake Drive, Itasca, IL 60143-3201. Additionally, you can refer to the U.S. Department of Labor Occupational Safety and Health Act (OSHA) 1910.213 Regulations.

**SYMBOLS**

**IMPORTANT:** Some of the following symbols may be used on your tool. Please study them and learn their meaning. Proper interpretation of these symbols will allow you to operate the tool better and safer.

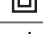
SYMBOL	NAME	EXPLANATION
V	Volts	Voltage (Potential)
A	Amperes	Current
Hz	Hertz	Frequency (Cycles per Second)
W	Watt	Power
Kg	Kilograms	Weight
	Alternating Current	Type of Current
	Direct Current	Type of Current
	Alternating or Direct Current	Type of Current
	Earthing Terminal	Grounding Terminal
	Class II Construction	Denotes Double Insulation
min	Minutes	Time
s	Seconds	Time
φ	Diameter	Size of Drill Bits, Grinding Wheels, etc.
$n_0$	No load speed	No-load Rotational Speed
.../min	Revolutions per Minute	Revolutions, Surface Speed, Strokes, etc. per Minute
1,2,3, ...	Ring Selector Settings	Speed, Torque or Position Settings

## FUNCTIONAL DESCRIPTION

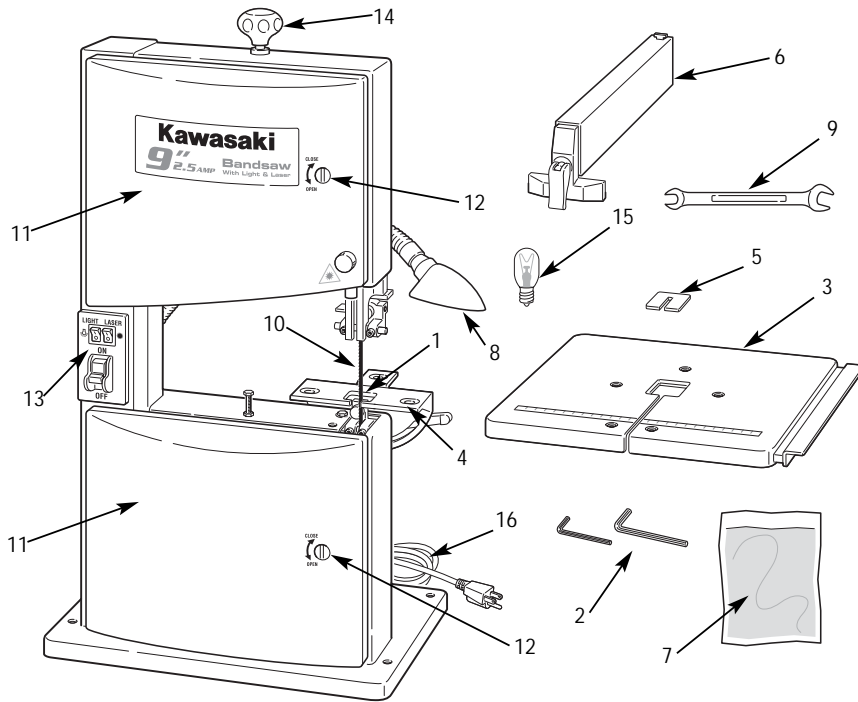

### CONTROLS AND COMPONENTS:

- |   |  |
|---|--|
| 1. Band Saw   | 10. 62" (1575mm) band saw blade (fitted) |
| 2. Hex Keys (2)   | 11. Wheel and Blade housing              |
| 3. Work Table   | 12. Door Latch                           |
| 4. Miter Gauge  | 13. Switches (ON/OFF, Light, Laser)      |
| 5. Table Insert   | 14. Blade Tension Knob                   |
| 6. Rip Fence  | 15. Light Bulb (15 watt)                 |
| 7. Recessed three hex bolts, washers and nuts (supplied in the bag) | 16. Grounded Power Cord                  |
| 8. Work Light   |  |
| 9. Open-end Wrench  |  |

## ASSEMBLY

The band saw is shipped partly disassembled.

Assembly consists of attaching the table, table insert, rip fence and miter gauge. Both the work table and rip fence must be installed prior to use. Assembly should take 10-15 minutes.

Required tools: The following tools are required: 4 mm Hex key (supplied), 3 mm Hex key (supplied) and open-end wrench (supplied).

### ASSEMBLING THE TABLE

1. Remove the bracket from below the work table by first loosening the two knobs.
2. Remove the two knobs, bracket and screws.
3. Place the work table on the table trunnion by threading the saw blade through the slot in the table.
4. Insert the table insert in the center of the table.
5. Align the work table so that the blade runs through the center of the table insert's slot.
6. Fasten the work table to the table trunnion using the three recessed hex bolts, plain washers and nuts. Caution: make sure the screws are tightened securely to ensure they do not loosen in use. Failure to do so can change the saw's performance.
7. Replace the bracket under the work table using the two screws and two thumb nuts.

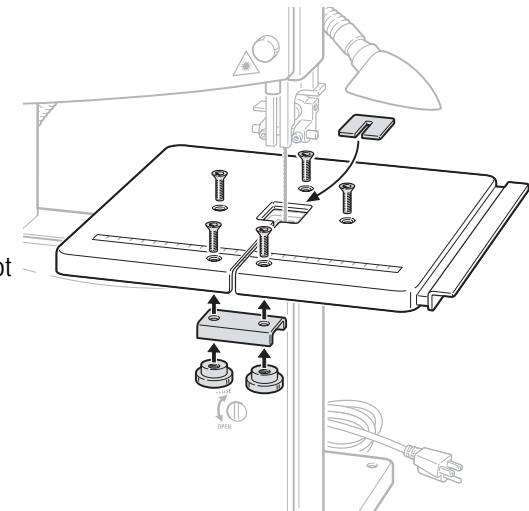

### NOTE

It may be necessary to rotate the handle counter-clockwise to be able to slide the rip fence over the table and then clockwise before locking the handle in position.

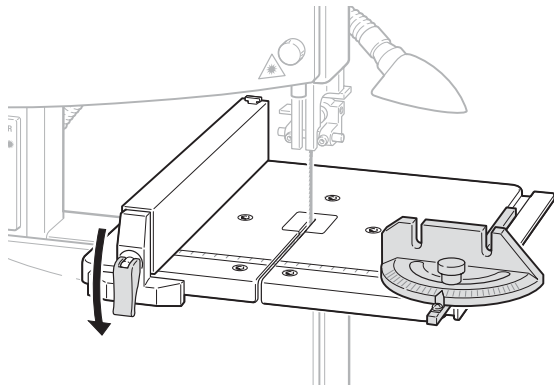

### INSTALLING THE WORKLIGHT

1. Insert a maximum 15 watt bulb into the socket of the light housing.
2. The light is located on a flexible tube allowing the worklight to be positioned onto the work area.

### OPERATING THE WORKLIGHT

1. To turn the worklight on press the light ON/OFF switch to the "I" position.
2. To turn the worklight off press the light ON/OFF switch to the "O" position.
3. To adjust the direction of the light move the worklight tube to the most suitable position.

### CONNECTING THE DUST COLLECTOR

**⚠ WARNING** Control wood dust and chips in a confined area and guard against all possible ignition sources. Failure to do so can result in fire and cause personal injury or death.

Connect the dust extraction equipment to the port on the back of the band saw.

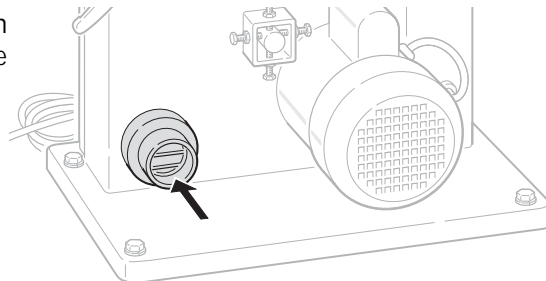

### MOUNTING THE SAW TO A WORKBENCH

The band saw has four predrilled holes in the base for mounting to a workbench. It is best to attach the band saw to a firm, stable surface at a convenient working height. A workbench is ideal.

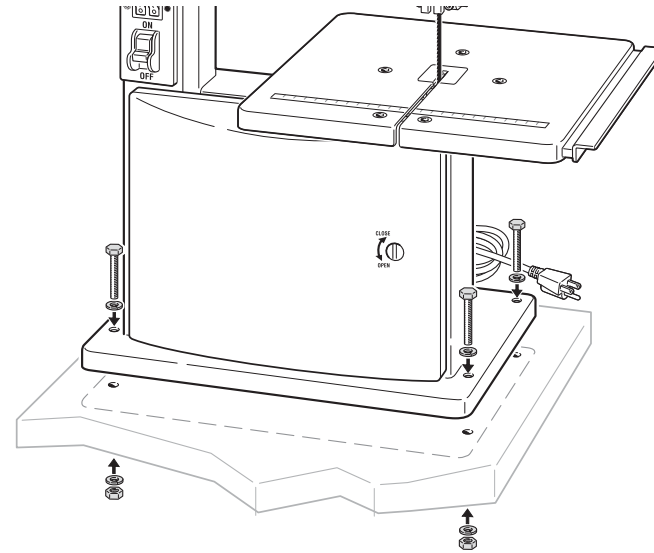

1. Drill four holes in the workbench to match the four holes in the base of the saw.
2. Attach the band saw to the work bench using bolts (inserted from the top), lock washers and nuts.

### OPENING THE HOUSING DOORS

The upper and lower housing doors protect the operator and shield the moving parts of the band saw drive and power source. The doors must remain closed while the band saw is in use.

**⚠ WARNING** Always remove power to the saw, by turning the power switch off and then unplugging it, before making any adjustments. Failure to do so can result in severe injury or death.

1. Remove power to the band saw by turning the switch off and unplugging at the power source.
2. To open the upper housing door, turn the upper housing locking screw to the left and then (pull) the door open.
3. To open the lower housing door, turn the lower housing locking screw to the left and then (pull) the door open.

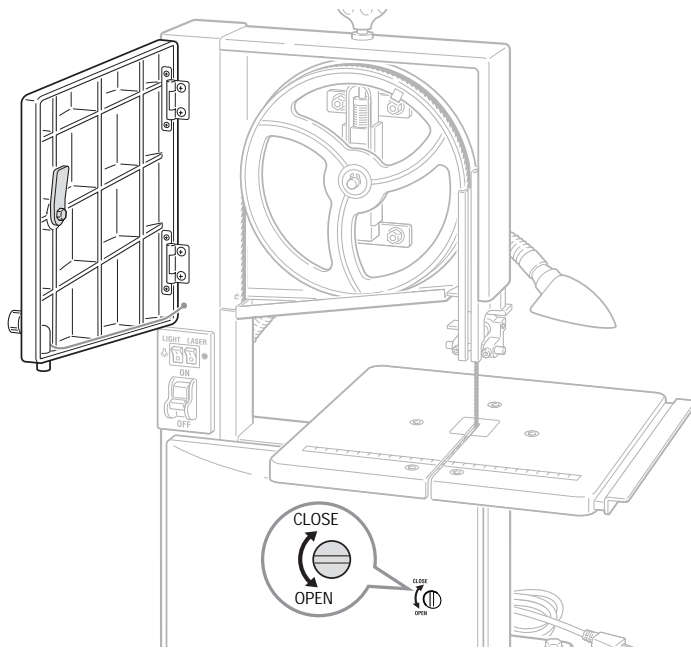

### ADJUSTING THE UPPER BLADE

The upper blade consists of a thrust bearing that supports the band saw blade from the rear and two guide bearings that provide lateral adjustment. These guide bearings need to be adjusted after every band saw change or any tracking adjustment. The upper blade guide protects against unintentional contact with the saw blade.

For the upper blade guide to provide adequate protection against contact with the band saw blade, it must always be set as close as possible against the work piece (maximum distance 1/8 inch).

1. To adjust the height of the upper blade guide loosen the blade guide locking knob and then adjust the height using the blade guide adjustment knob.
2. Tighten the blade guide locking knob to secure the upper blade guide in position.

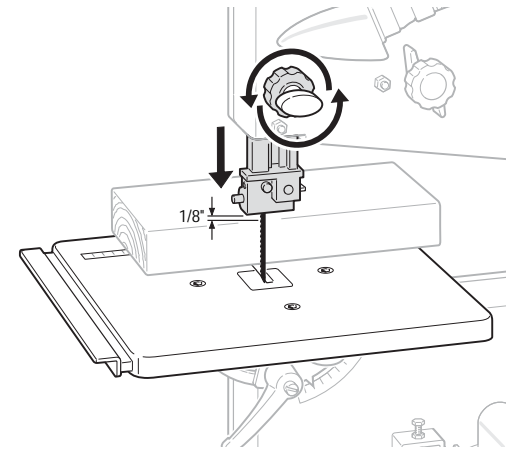

### ADJUSTING THE THRUST BEARING

The thrust bearing must be adjusted after every band saw blade change or tracking adjustment.

1. Loosen the thrust bearing locking screw with the Allen key supplied.
2. Adjust the bearing position until it is 1/32-inch away from the band saw blade. When the band saw blade is turned by hand, it should not contact the thrust bearing.
3. Tighten the thrust bearing locking screw.

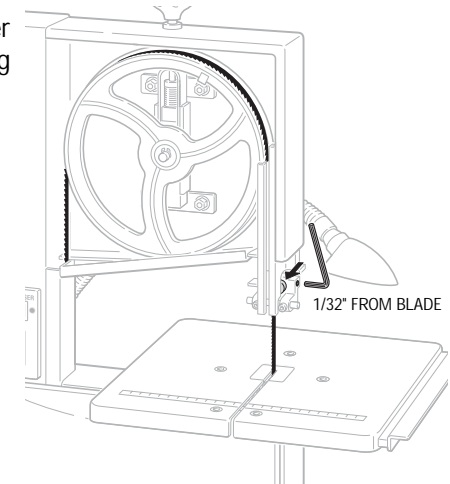

#### **⚠ WARNING**

Always ensure that the saw is switched off and unplugged from the power supply before making any adjustments. Failure to do so can cause electrical shock, injury or death.

### ADJUSTING THE UPPER GUIDE BEARING

1. Loosen the two screws that hold the guide pins in place using the Allen key.
2. Press the guide pins together against the band saw blade.
3. Turn the band saw wheel by hand in a clockwise direction several times to bring the guide pins into position. Both guide pins should touch the saw blade.
4. Tighten the guide pin locking screws.
5. Rotate the band saw tensioner wheel one or two times to ensure straight tracking of the band saw blade.

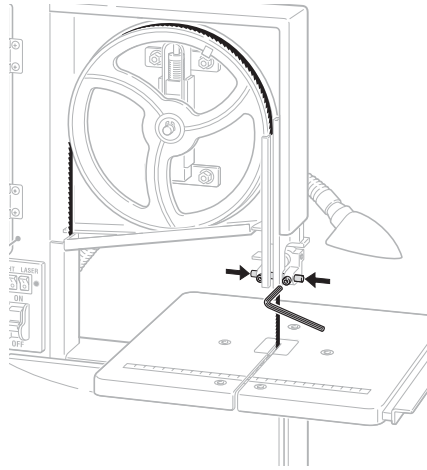

### ADJUSTING THE LOWER BLADE GUIDE

The lower blade guide has a thrust bearing that supports the band saw blade from the rear and two guide bearings that provide lateral adjustment. These guide bearings need to be adjusted after every band saw change or any tracking adjustment.

1. Tilt the work table 45 degrees to give access to the adjustment screws.
2. To adjust the thrust bearing, loosen the thrust bearing locking screw with the Allen wrench.
3. Adjust the bearing position until it is 1/32-inch from the band saw blade. When adjusted correctly the band saw blade, when turned by hand, will not contact the thrust bearing.
4. Tighten the thrust bearing locking screw.
5. Open the lower housing door to access the two screws that hold the guide pins in place. Then, with the table trunnion level, adjust the guide pins by loosening the screws with the Allen key.

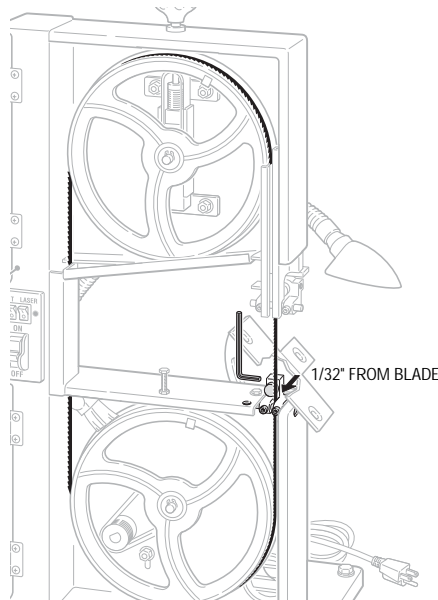

17

NOTE: The right guide pin is accessed through the slot in the lower housing.

6. Press the guide pins together against the band saw blade.
7. Turn the band saw wheel by hand several times in a clockwise direction to bring the guide pins into the correct position. Both guide pins should just touch the saw blade.
8. Tighten the guide pin locking screws.
9. Rotate the band wheel one or two times by hand to ensure that the blade is not pinched.

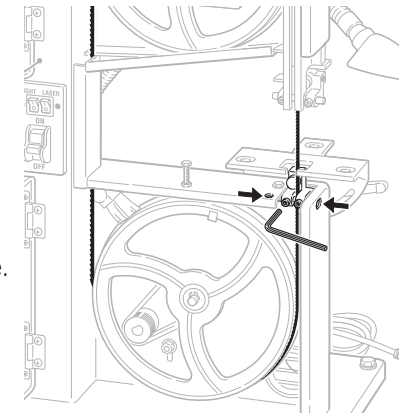

### ADJUSTING THE RIP FENCE

The rip fence attachment allows you to make parallel cuts in a piece of wood, all the same width.

**WARNING** Always remove power the saw, by turning the power switch off and then unplugging it, before making any adjustments. Failure to do so can result in severe injury or death.

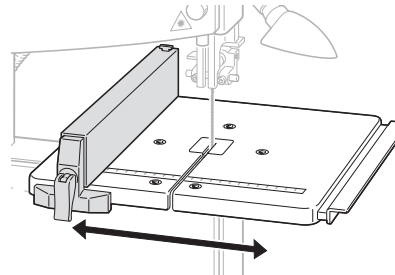

1. Adjust the rip fence to the desired width and secure it in position using the locking handle.

NOTE: The rip fence can be positioned on both sides of the blade.

2. Ensure that the rip fence rests against the wood long its entire length to produce a consistent parallel cut.

### ADJUSTING THE MITER GAUGE

The miter gauge is used to help support the work piece and can be adjusted when cutting an angle.

1. To adjust, loosen the knob at the top of the miter gauge.
2. Rotate the miter gauge until the desired angle is reached.
3. Tighten the miter gauge knob to lock the angle in position.

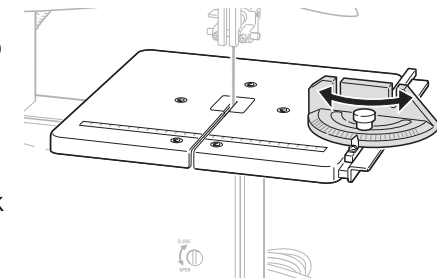

## ADJUSTING THE BEVEL ANGLE

The bevel adjustment allows material to be cut at any angle between 0 and 45 degrees.

**⚠ WARNING** Always remove power to the saw by turning the power switch off and then unplugging it, before making any adjustments. Failure to do so can result in severe injury or death.

1. Loosen the table locking knob.

NOTE: the table setting lever works on a cam allowing you to pull it toward you and back if you run out of room.

2. Loosen the table setting lever.
3. Adjust the bevel adjustment scale located under the table to help set the table to the desired angle between 0 and 45 degrees.
4. Tighten the table setting lever and the table locking knob to secure the table in position.
5. Make a practice cut on a scrap piece of similar wood and adjust the table as needed for precision.

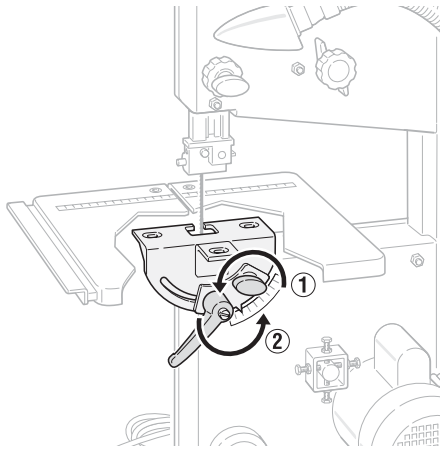

## ADJUSTING SAW BLADE TENSION

**⚠ WARNING** Always remove power to the saw by turning the power switch off and then unplugging it, before making any adjustments. Failure to do so can result in severe injury or death.

1. To increase blade tension, turn the blade tension knob clockwise.
2. To reduce blade tension, turn the blade tension knob counterclockwise.
3. Fully raise the upper blade guide.
4. Check the tension by pushing the side of the blade, halfway between the table and upper blade guide, with your finger. The blade should bend no more than 5/64 to 1/8 inch.
5. Correct the tension as needed by turning the blade tension knob and then measuring bending again.

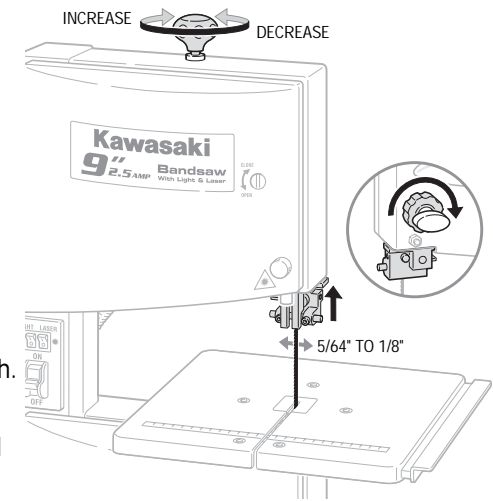

## ADJUSTING BLADE TRACKING

This procedure is followed to ensure that the blade is centered on the band saw wheels.

**⚠ WARNING** Always remove power to the saw, by turning the power switch off and then unplugging it, before making any adjustments. Failure to do so can result in severe injury or death.

1. Unlock and open the housing doors.
2. Loosen the blade tracking locking nut.
3. While rotating the band saw wheel by hand, turn the blade tracking adjustment knob: clockwise if the blade runs toward the front of the saw or counterclockwise if the blade runs toward the back.
4. When tracking properly, tighten the blade tracking nut.

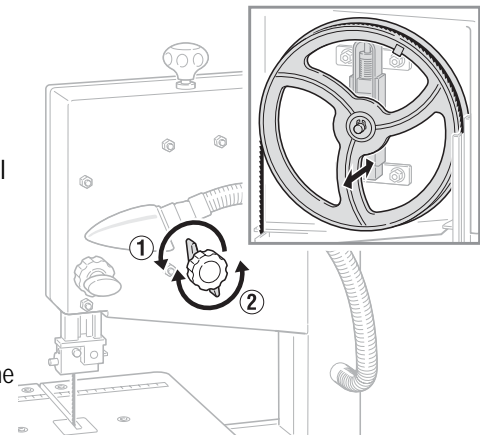

## SETTING THE TABLE SQUARE WITH THE BLADE

**⚠ WARNING** Always remove power the saw, by turning the power switch off and then unplugging it, before making any adjustments. Failure to do so can result in severe injury or death.

1. Fully raise the upper blade guide.
2. Check that the band saw tension is correct.
3. Loosen the table locking knob and table setting lever.
4. Using a square, adjust the work table at a right angle to the blade.
5. Tighten the table locking knob and table setting lever.
6. Loosen the locking nut located beneath the work table and adjust the screw stop until it touches the work table.
7. Tighten the locking nut to secure the screw stop in position.
8. Check that the blade is 90 degrees to the table by making a practice cut on a scrap piece of similar wood and checking that it is square.

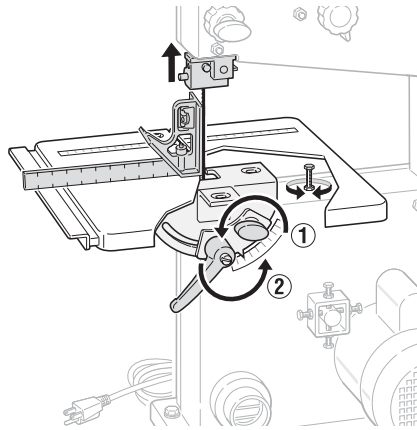

## INSTALLING THE BAND SAW BLADE

This band saw is equipped with a general-purpose wood cutting blade.

**⚠ WARNING** Always remove power to the saw, by turning the power switch off and then unplugging it, before installing the blade. Failure to do so can result in severe injury or death.

1. Remove the rip fence from the table.
2. Remove the bracket from under the work table by loosening the two knobs.
3. Open both housing doors.
4. Loosen the blade tension knob to remove tension from the blade.
5. Remove the blade by guiding it through the slot in the work table, the upper blade guide and the blade cover on the saw housing.

NOTE: Use only recommended blades for the job.

6. Fit the new blade in place, ensuring that the teeth point toward the front of the saw (doors).
7. Apply tension to the new blade by rotating the blade tension knob.
8. Center the band saw blade on the band saw wheel.
9. Turn the upper wheel by hand to ensure the blade is centered on the wheels.
10. Adjust saw blade tracking as needed (see procedure).
11. Close both housing doors.
12. Swing the lower blade guide back into position.
13. Attach the (U-clamp) under the work table with two screws provide and two thumb nuts.
14. Attach the rip fence to the table and secure it by pushing the locking handle down.

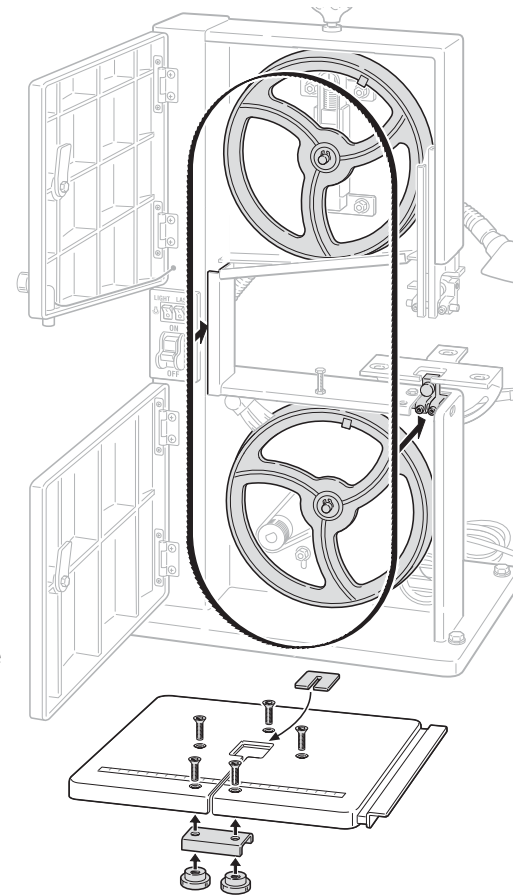

## LASER GUIDE

**⚠ CAUTION** Use of controls or procedures, or performance of procedures other than those specified herein may result in hazardous radiation exposure.

## LASER SAFETY

### **WARNING**

**NEVER LOOK INTO THE LASER BEAM.** Any contact with the eyes by the beam could cause injury. Do not use the laser when cutting reflective materials.

**DO NOT AIM THE LASER BEAM AT ANYONE OR AT REFLECTIVE SURFACES. CLASS 2M LASER PRODUCT.** Any contact with the eyes by the beam could cause injury. Ensure the laser beam is turned on only when the tool is on a non-reflective workpiece and as such it is aimed only at the work surface. Metals and other materials like steel which can be highly reflective should only be cut without the use of the laser.

**STORE OUT OF REACH OF CHILDREN.** Equipment should be in a high location or locked up to keep out of reach of children. It is not a toy.

**DO NOT TAMPER WITH THE LASER OUTPUT.** Changing the performance of the laser to increase its output is prohibited. Any claim for damages or injuries resulting from not following these instructions will be refused.

#### OPERATION ACCESSIBLE FIELDS:

Wavelength	636-660nm
Laser Power for Classification	<1mW CW

**NEVER OPERATE LASER IF THE UNIT IS DEFECTIVE OR THE COVER OR SEAL IS DAMAGED.**

**DO NOT SERVICE LASER.** The laser unit must be returned to the factory for any service or repair. Service or repair must be handled by authorized factory trained technicians.

Be careful with this tool. Striking or jarring it, especially on the laser housing, can affect its accuracy.

## OPERATING THE LASER

### **CAUTION**

Do not stare into the laser beam. Never aim the beam at any person or an object other than the work piece. The use of optical instruments with this laser product will increase the chance of eye damage.

#### USING THE LASER LIGHT

1. Place the workpiece on the table.
2. Press the laser light ON/OFF switch to the "I" position.
3. To turn the laser light off press the laser light ON/OFF switch to the "O" position.
4. To adjust the laser line turn the laser adjustment knob in a counter-clockwise direction to loosen it and then move it to the left or right until the laser line is in line with blade. Turn the laser adjustment knob in a clockwise direction to tighten.

The laser guide does not normally present an optical hazard, although staring at the beam may cause flash blindness.

The laser shall be used and maintained in accordance with the manufacturer's instructions.

Always ensure the laser beam is aimed at a sturdy work piece without a reflective surface, i.e. wood or rough coated surfaces are acceptable. Bright shiny reflective sheet or the like is not suitable for laser use as the defective surface could direct the beam back at the operator.

### **WARNING**

It may be more difficult to see the laser line in conditions of bright sunshine and on certain surfaces.

## OPERATING THE BAND SAW

Before operating the band saw, the unit should be fully assembled and prepared for use. All doors should be closed and locked and appropriate safety procedures followed.

1. With power removed from the equipment, perform a pre-operation check: Check for damaged parts. Check that guards are in place. Check for alignment of moving parts, binding of moving parts, breakage of parts, mounting, and any other conditions that may affect its operation.
2. Correct all unsafe conditions. Any part that is damaged should be properly repaired or replaced.

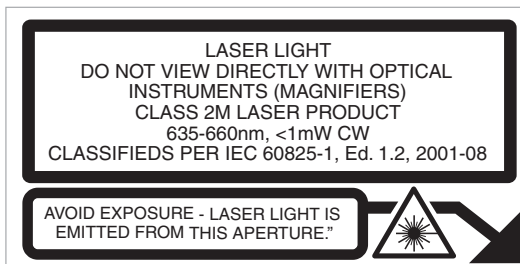

LASER RADIATION  
CAUTION LABEL

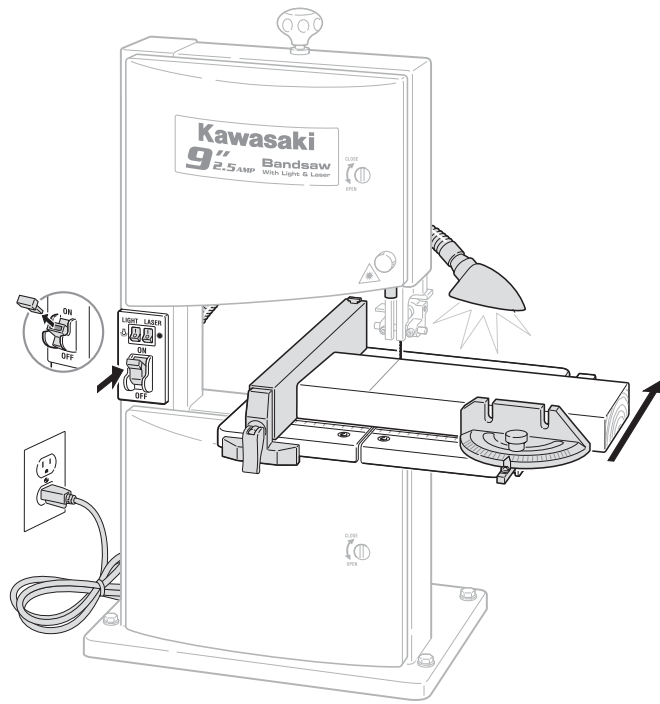

### FEEDING WORK INTO THE SAW

1. Ensure that the lighting is adequate.
2. Adjust the upper guide to just clear the work piece.
3. Inspect the work piece and remove all nails and other foreign objects before beginning sawing.
4. Hold the work piece firmly against table.
5. Feed the piece work into the blade against the direction of rotation of the blade.
6. Should the blade become jammed, immediately turn the machine switch OFF and wait for the blade to come to a full and complete stop. Unplug the saw from the power source and then proceed to gently disengage the piece from the blade.

### MAINTENANCE AND CLEANING

It is important to keep your band saw in perfect operating condition.

#### CLEANING

After every use of the band saw, the saw and surrounding area should be cleaned thoroughly to remove any buildup of metal filings. Use an air hose or soft bristled brush to clean the saw components. Sweep around the saw or use a shop vacuum to remove the debris from the floor.

### ACCESSORIES

Optional accessories for the band saw can include wire-brush wheels that can be used for cleaning and layered cloth wheels that can be used for polishing and buffing. Contact **ALLTRADE Customer Service at 1-800-590-3723 (toll free)** to find out what accessories are available for the band saw.

**⚠ WARNING** Only use accessories that are designed to fit your particular band saw. These accessories should be specifically labeled to match the speed and arbor size of the band saw. Failure to use the proper accessories could result in property damage, damage to the band saw, and serious personal injury to the operator.

Always attach grounded (3-prong) extension cords to grounded (3-hole) outlets. If the band saw must be used outside, use an extension cord labeled "W-A" or "W." These extension cords are rated for outdoor use and reduce the chances of electrical shock.

If you must use an extension cord, be sure that the gauge is large enough to carry the amount of current necessary for your power tool. If not, your tool may experience a loss of power, excessive voltage drop or overheating. The smaller the gauge number, the heavier the cord (see table on below).

#### RECOMMENDED SIZES OF EXTENSION CORDS 120 VOLT AC 60 HZ TOOLS

TOOL CURRENT RATING	CONDUCTOR SIZE IN A.W.G			
	AMPERE	10FT.	25FT.	50FT.
3-6	18	18	18	18
6-8	18	18	18	16
8-10	18	18	18	14
10-12	16	16	14	14
12-16	14	12	12	-
16-20	12	12	12	-

## SPECIFICATIONS

### SPECIFICATIONS

Input	120V  60 Hz
Current	2 A
Cutting Speed	2650 SF/M
Blade Length	59 1/2" (1511mm)
Throat Capacity	9" (229mm)
Table Size	11 13/16" X 11 13/16" (300mm x 300mm)
Max Cutting Height	3 1/2" (89mm)
Laser Beam	Class II, Diode Laser
Average Radiant Power	1mw
Laser Beam Wavelength	650nm

### OTHER CONSUMER DO-IT-YOURSELF (DIY) TOOLS

Alltrade offers a full range of Kawasaki™ tools that make DIY jobs easy. If you would like further information on the following products, please contact Alltrade Customer Service Department at 1-800-590-3723.

Cordless Drills/Screwdrivers	Reciprocating Saws
Impact Wrenches	Routers
Sanders	Rotary Tools
Jigsaws	Corded and Cordless Multi-Purpose Tools
Circular Saws	Wide Range of Accessories and more
Angle Grinders	

### 3 YEAR LIMITED WARRANTY

#### Express and Exclusive Limited Warranty to Original Retail Buyer

Alltrade Tools LLC (hereinafter "Alltrade") expressly warrants to the original retail purchaser of the accompanying KAWASAKI™ power tool and no one else all parts of the product (except those parts referred to below which are specifically excluded from such warranty (see Exclusions)) to be free from defects in materials and workmanship for a period of three years from original date of purchase, except that such warranty with regard to the battery shall be for a period of two years from original date of purchase, unless the tool is used for commercial or rental purposes.

**SPECIAL WARRANTY NOTE FOR COMMERCIAL OR RENTAL USE:** The above warranty for this Kawasaki™ power tool, including the battery, shall be effective for only 90 days from the original date of purchase if this tool is used for any **COMMERCIAL OR RENTAL PURPOSE.**

The date of purchase shall be the date of shipment to the original purchaser, or the date the original purchaser took possession, custody or control of the product, whichever occurred first. This warranty shall be null and void if the product or any component thereof is modified or altered. This warranty does not apply to any other product and/or component thereof manufactured or distributed by Alltrade, and does not apply to products and/or components thereof designed, manufactured and/or assembled by others, for which Alltrade makes no warranties whatsoever. **THERE ARE NO WARRANTIES WHICH EXTEND BEYOND THE DESCRIPTION ON THE FACE HEREOF.**

#### Warranty Performance

By purchasing the product, purchaser expressly acknowledges and agrees that their sole and exclusive remedy under this warranty shall be strictly limited to the repair or replacement of any covered nonconforming items or parts thereof provided that any such nonconforming item and/or part is promptly returned to Alltrade's facility postage pre-paid and insured (address: ALLTRADE Warranty Claims & Repair, 1431 Via Plata, Long Beach, CA 90810, Attn: Customer Service #1-800-590-3723) within the applicable warranty period, with a written request by purchaser that Alltrade repair and/or replace the nonconforming item and/or part. We recommend that you keep the original product packaging in the event you need to ship the unit. We suggest the package be insured against loss or in transit damage. When sending your product include your name, address, phone number, dated proof of purchase (or copy), and a statement about the nature of problem. Warranty coverage is conditioned upon purchaser furnishing Alltrade with adequate written proof that they are the original purchaser and of the original purchase date. Parts returned, freight prepaid and insured, to Alltrade's facility (see above address) will be inspected and, at Alltrade's option, repaired and/or replaced free of charge if found to be defective and subject to warranty. Alltrade retains the sole discretion to determine whether any item or part is nonconforming and, if so, whether the item and/or part will be repaired and/or replaced. If the unit is repaired, new or reconditioned replacement parts may be used. If Alltrade chooses to replace the product, it may replace it with a new or reconditioned one of the same or comparable design. The repaired or replaced unit will be warranted under the terms of the remainder of the warranty period. Typically, a defective product that is returned within the first 30 days after the purchase date will be replaced; for items returned after the first 30 days and within the warranty period, covered defective parts not subject to normal wear and tear or other exclusions will be repaired or replaced, at Alltrade's option. During the warranty period, Alltrade will be responsible for the return shipping charges. Alltrade's repair and/or replacement of any nonconforming item and/or part thereof shall constitute fulfillment of all obligations to the purchaser. Alltrade shall not be responsible or liable for any expense, including freight charges, or repairs made outside Alltrade's facility, unless expressly agreed to by Alltrade in writing. Under no circumstances shall Alltrade bear any responsibility for loss of the unit, loss of time or rental, inconvenience, commercial loss or consequential damages.

## **Exclusions**

This warranty does not cover parts damaged due to normal wear, abnormal conditions, misapplication, misuse, abuse, accidents, operation at other than recommended pressures or temperatures, improper storage or freight damage. Parts damaged or worn by operation in dusty environments are not warranted. Failure to follow recommended operating and maintenance procedures also voids warranty.

This limited warranty does not apply to accessory items such as drill bits, screwdriving bits, circular saw blades, jigsaw blades, grinding wheels, sanding sheets and other related items.

DAMAGE TO THE PRODUCT RESULTING FROM TAMPERING, ACCIDENT, ABUSE, NEGLIGENCE, FAILURE TO FOLLOW INSTRUCTIONS, UNAUTHORIZED REPAIRS OR ALTERATIONS, DAMAGE WHILE IN TRANSIT TO OUR SERVICE FACILITY, USE OF UNAPPROVED OR IMPROPER ATTACHMENTS OR ACCESSORIES, COMMERCIAL AND RENTAL APPLICATIONS OR OTHER CAUSES UNRELATED TO PROBLEMS WITH MATERIAL OR WORKMANSHIP ARE NOT COVERED BY THIS WARRANTY.

Alltrade will not be liable for the following: labor charges, loss or damage resulting from improper operation, maintenance or repairs made by other persons; pre-delivery services such as assembly, oil or lubricants, and adjustment; maintenance services that are normally required to maintain the product.

The use of other than genuine Alltrade Repair Parts will void warranty.

## **Warranty Disclaimers**

EXCLUSION AND DISCLAIMER OF ALL OTHER EXPRESS WARRANTIES, GUARANTIES AND/OR REPRESENTATIONS. EXCEPT FOR THE LIMITED WARRANTY PROVIDED ABOVE, ALL OTHER EXPRESS WARRANTIES, GUARANTIES AND/OR REPRESENTATIONS BY ALLTRADE AND/OR ITS REPRESENTATIVE(S) REGARDING THE DESIGN, MANUFACTURE, PURCHASE, USE AND/OR OPERATION OF THE PRODUCT OR ANY COMPONENT THEREOF SOLD HEREUNDER, REGARDLESS OF WHETHER ANY SUCH WARRANTY, GUARANTY AND/OR REPRESENTATION, WRITTEN OR ORAL, ARISES BY OPERATION OF LAW AND/OR EQUITY AND/OR BY ANY ACT OR OMISSION OF ALLTRADE AND/OR ITS REPRESENTATIVE(S), OR THE BUYER, ARE HEREBY EXPRESSLY EXCLUDED AND DISCLAIMED BY ALLTRADE AND/OR ITS REPRESENTATIVES. PURCHASER KNOWINGLY AND WILLINGLY WAIVES ANY AND ALL SUCH WARRANTIES AND RIGHTS, CLAIMS AND/OR CAUSES OF ACTION ARISING THEREFROM OR BASED THEREON. PURCHASER'S SOLE AND EXCLUSIVE REMEDY IS AS STATED ABOVE.

EXCLUSION AND DISCLAIMER OF ALL IMPLIED WARRANTIES, INCLUDING THE IMPLIED WARRANTIES OF MERCHANTABILITY AND FITNESS FOR A PARTICULAR

PURPOSE. NO WARRANTY, ORAL OR WRITTEN, OTHER THAN THE ABOVE WARRANTY IS MADE WITH REGARD TO THIS PRODUCT. ALL EXPRESS AND/OR IMPLIED WARRANTIES, GUARANTIES AND/OR REPRESENTATIONS BY ALLTRADE AND/OR ITS REPRESENTATIVE(S) REGARDING THE DESIGN, MANUFACTURE, PURCHASE, USE AND/OR OPERATION OF THE PRODUCT OR ANY COMPONENT THEREOF SOLD HEREUNDER, REGARDLESS OF WHETHER ANY SUCH WARRANTY, GUARANTY AND/OR REPRESENTATION, WRITTEN OR ORAL, ARISES BY OPERATION OF LAW AND/OR EQUITY AND/OR BY ANY ACT OR OMISSION OF ALLTRADE AND/OR ITS REPRESENTATIVE(S), OR THE PURCHASER, INCLUDING BUT NOT LIMITED TO THE IMPLIED WARRANTY OF MERCHANTABILITY AND THE WARRANTY OF FITNESS FOR A PARTICULAR PURPOSE, ARE HEREBY EXPRESSLY EXCLUDED AND DISCLAIMED BY ALLTRADE AND/OR ITS REPRESENTATIVES. PURCHASER KNOWINGLY AND WILLINGLY WAIVES ANY AND ALL SUCH WARRANTIES AND RIGHTS, CLAIMS AND/OR CAUSES OF ACTION ARISING THEREFROM OR BASED THEREON. PURCHASER'S SOLE AND EXCLUSIVE REMEDY IS AS STATED ABOVE.

## **Limitation Of Liability**

IN NO EVENT SHALL ALLTRADE AND/OR ITS REPRESENTATIVE(S) BE LIABLE FOR INDIRECT, INCIDENTAL, SPECIAL AND/OR CONSEQUENTIAL DAMAGES OF ANY KIND ARISING OUT OF OR RELATED TO, DIRECTLY OR INDIRECTLY, ANY BREACH OF ANY PROVISION OF ANY AGREEMENT BETWEEN ALLTRADE AND/OR ITS REPRESENTATIVE(S) AND PURCHASER, ANY WARRANTY HEREUNDER, AND/OR THE EXISTENCE, DESIGN, MANUFACTURE, PURCHASE, USE AND/OR OPERATION OF ANY ITEM(S) SOLD HEREUNDER EVEN IF ALLTRADE AND/OR ITS REPRESENTATIVE(S) HAS BEEN ADVISED OF THE POSSIBILITY OF ANY SUCH DAMAGES. IN NO EVENT, WHETHER AS A RESULT OF A BREACH OF CONTRACT, WARRANTY, TORT (INCLUDING NEGLIGENCE) OR OTHERWISE, SHALL ALLTRADE'S AND/OR ITS REPRESENTATIVE(S)' LIABILITY EXCEED THE PRICE OF THE PRODUCT. ANY AND ALL LIABILITY CONNECTED WITH THE USE OF THIS PRODUCT SHALL TERMINATE UPON THE EXPIRATION OF THE WARRANTY PERIODS SPECIFIED ABOVE.

## **Limitations on Warranty Disclaimers**

Some states do not allow limitations on how long an implied warranty lasts and some states do not allow the exclusion or limitation of the incidental or consequential damages, so part or all of the above limitations or exclusions may not apply to you. This warranty gives you specific legal rights, and you may also have other rights which vary from state to state.

If your product is not covered by this warranty, please call our Customer Service Department toll free at 1-800-590-3723 for general repair information and charges.